

PROJECT NO.	SHEET NO.
M-275-5(1036)	1
▲ CONTROL NO.	32265
▲ CONTROL NO.	
■ CONTROL NO.	

INDEX OF SHEETS

SHEET NO.	
1	TITLE PAGE
2-T1	TYPICAL CROSS SECTIONS
2-S1	SUMMARY OF QUANTITIES
3-5	CONSTRUCTION PLANS

STANDARD PLANS

501-R6	(3 SHEETS) EROSION CONTROL
920-R6	(3 SHEETS) TRAFFIC CONTROL, CONSTRUCTION AND MAINTENANCE
922-R9	(2 SHEETS) TRAFFIC CONTROL FOR ASPHALT SURFACING

STATE OF NEBRASKA
DEPARTMENT OF ROADS
PLANS FOR CONSTRUCTION
**ELKHORN RIVER BRIDGE
NORTH OF OAKDALE**
ANTELOPE COUNTY

THE 2007 EDITION OF THE NEBRASKA STANDARD SPECIFICATIONS AND THE SPECIAL PROVISIONS APPLY TO THIS PROJECT.

THE WORK ON THIS PROJECT CONSISTS OF GROUPS	
1-GRADING	
▲ GROUPS 1	ARE INCLUDED
IN THE LETTING OF MAY 19, 2016	
▲ GROUPS	ARE INCLUDED
IN THE LETTING OF	
■ GROUPS	ARE INCLUDED
IN THE LETTING OF	

DESIGN DESIGNATION
MAINTENANCE
TRAFFIC
YEAR: 2015
ADT: N/A

WORK ON THIS PROJECT IS AUTHORIZED PURSUANT TO THE CONDITIONS STIPULATED IN THE ARMYCORPS OF ENGINEERS GENERAL/NATIONWIDE/INDIVIDUAL PERMIT

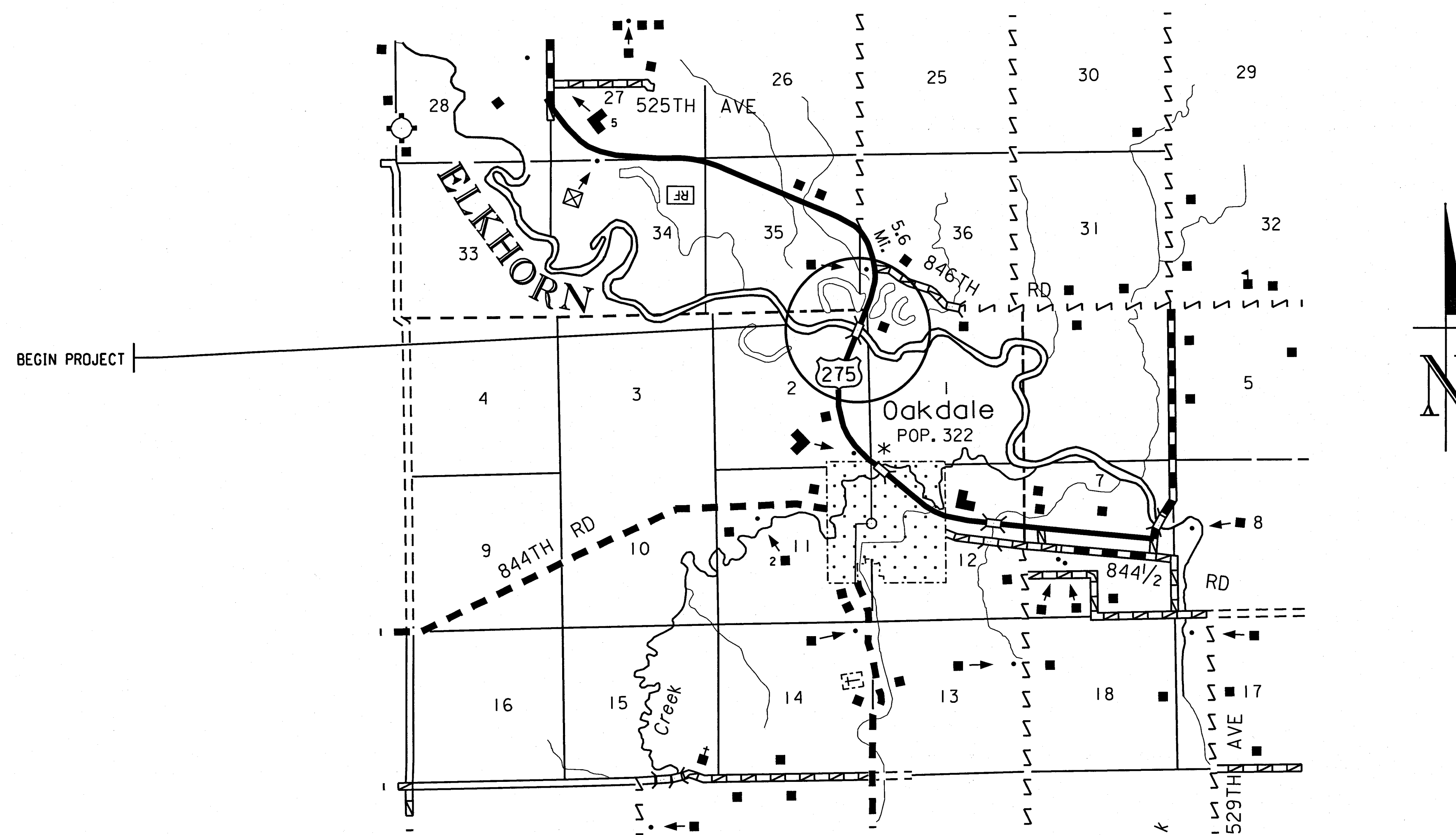

CONVENTIONAL SIGNS

FENCE R.O.W. OR WIRE	
GUARDRAIL	
TRAVELED WAY	
DIKE	
CULVERT	
POWER POLE	
TELEPHONE POLE	
MAILBOX	
RAILROAD TRACKS	
MARSH	
TREE - CONIFEROUS	
TREE - DECIDUOUS	

R.O.W. LEGEND

NEW CONTROLLED ACCESS	
PREVIOUS CONTROLLED ACCESS	
LIMITS OF CONSTRUCTION	
PREVIOUS R.O.W.	
NEW R.O.W.	
EXISTING PERMANENT EASEMENT	
TEMPORARY EASEMENT	
EXCESS TAKING	
PERMANENT EASEMENT	
EXISTING RAILROAD EASEMENT	
NEW RAILROAD PERMANENT EASEMENT	
NEW RAILROAD TEMPORARY EASEMENT	

REFERENCE POST NO. 45.15 TO REFERENCE POST NO.
EXCEPTIONS: FROM STA. TO STA.
TOTAL NET LENGTH OF PROJECT: 0 FEET 0 MILES

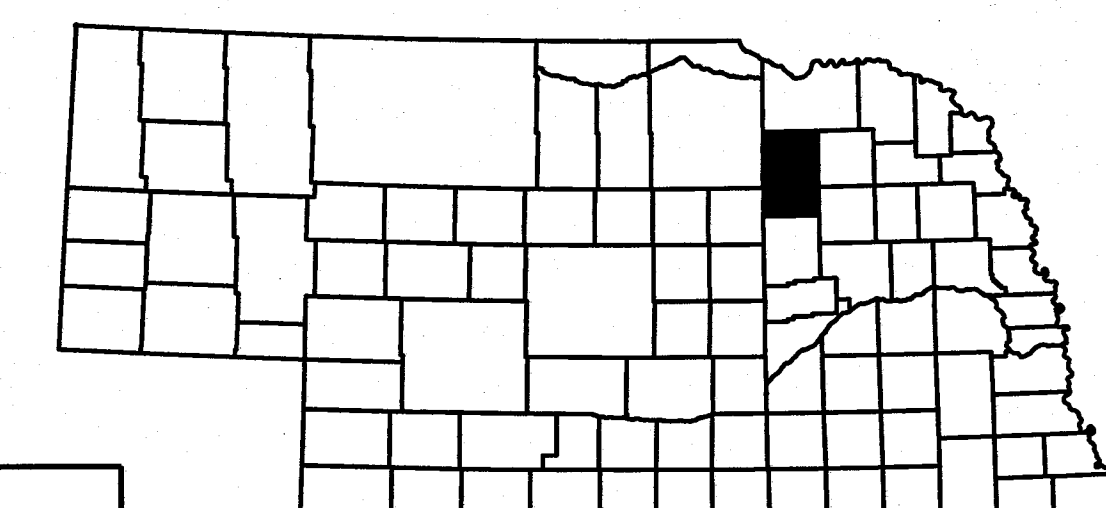
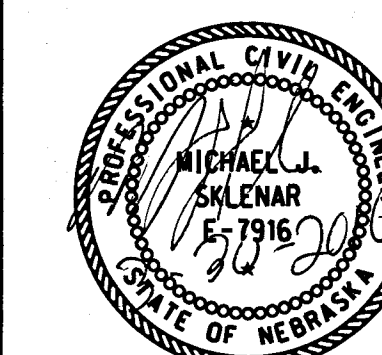
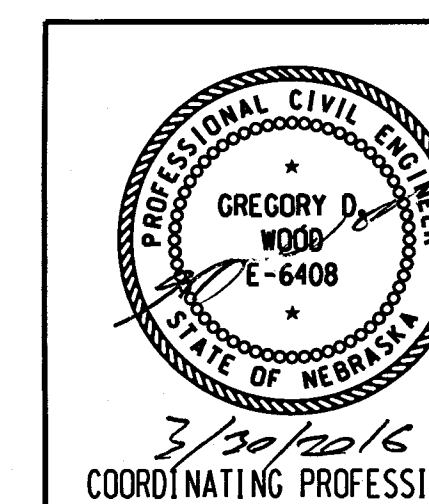

CONSTRUCTION DIVISION
COMPUTER\$\$\$\$
USERNAME\$\$\$\$
DATE\$
DGN\$SPEC\$
SCALE\$

PROJECT NO.	SHEET NO.
275-5 (1036)	2-T1
C.N. 32265	

TYPICAL CROSS SECTIONS

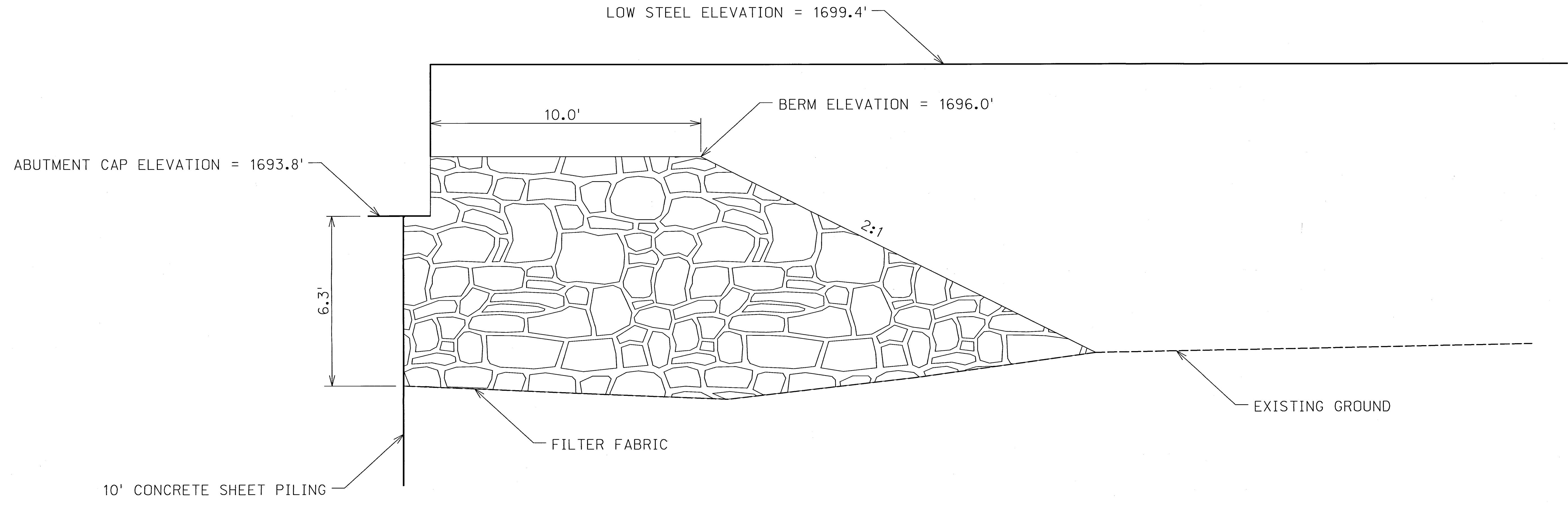

ROADWAY DESIGN DIVISION

Computer: DRNDRFLK12

User: dor33099

Date: 17-MAR-2016 12:55

File: M30016d3d101.dgn
Scale: 1:2

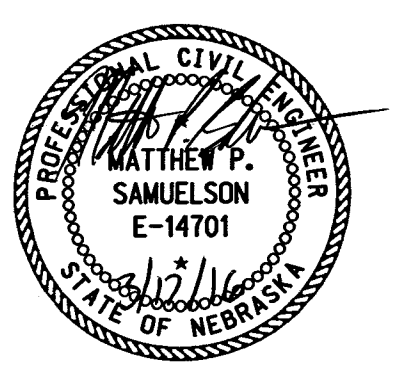

PROJECT NO.	SHEET NO.
M-275-5(1036)	2-51

CONTROL NO. 32265

SUMMARY OF QUANTITIES

GRADING ITEMS GROUP 1

ITEM	QUANTITY	UNITS
TEMPORARY SIGN DAY	32.000	EACH
FLAGGING	16.000	DAY
MOBILIZATION	1.000	LUMP
RIPRAP FILTER FABRIC	240.000	SY
ROCK RIPRAP, TYPE C	600.000	TON
TEMPORARY ROCK RIPRAP, TYPE C	330.000	TON
RENTAL OF LOADER, FULLY OPERATED	5.000	HOUR
RENTAL OF DUMP TRUCK, FULL OPERATED	5.000	HOUR
RENTAL OF SKID LOADER, FULLY OPERATED	5.000	HOUR
RENTAL OF CRAWLER MOUNTED HYDRAULIC EXCAVATOR, FULLY OPERATED	5.000	HOUR
EROSION CONTROL, CLASS 1D	65.000	SY
ENVIRONMENTAL COMMITMENTS - CONTRACTOR COMPLIANCE	1.000	LUMP

CONSTRUCTION DIVISION

COMPUTER\$\$\$\$

USERNAME\$\$\$\$

DATE\$\$\$\$\$\$\$\$\$\$\$\$\$\$\$\$

DGN\$P\$C\$\$\$\$\$\$\$\$\$\$\$\$\$\$\$\$\$
SCALE\$\$\$\$\$\$\$\$\$\$\$\$\$\$\$\$\$

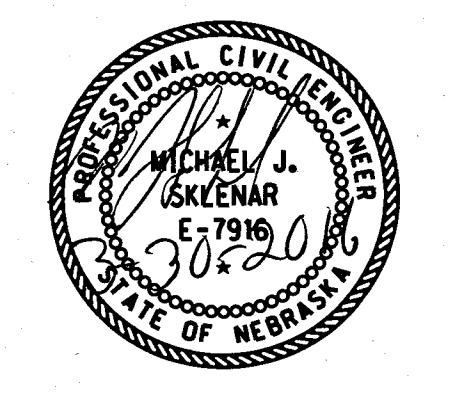

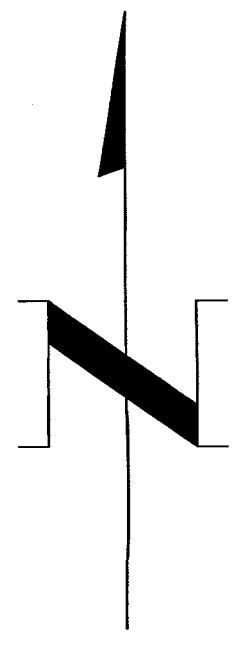
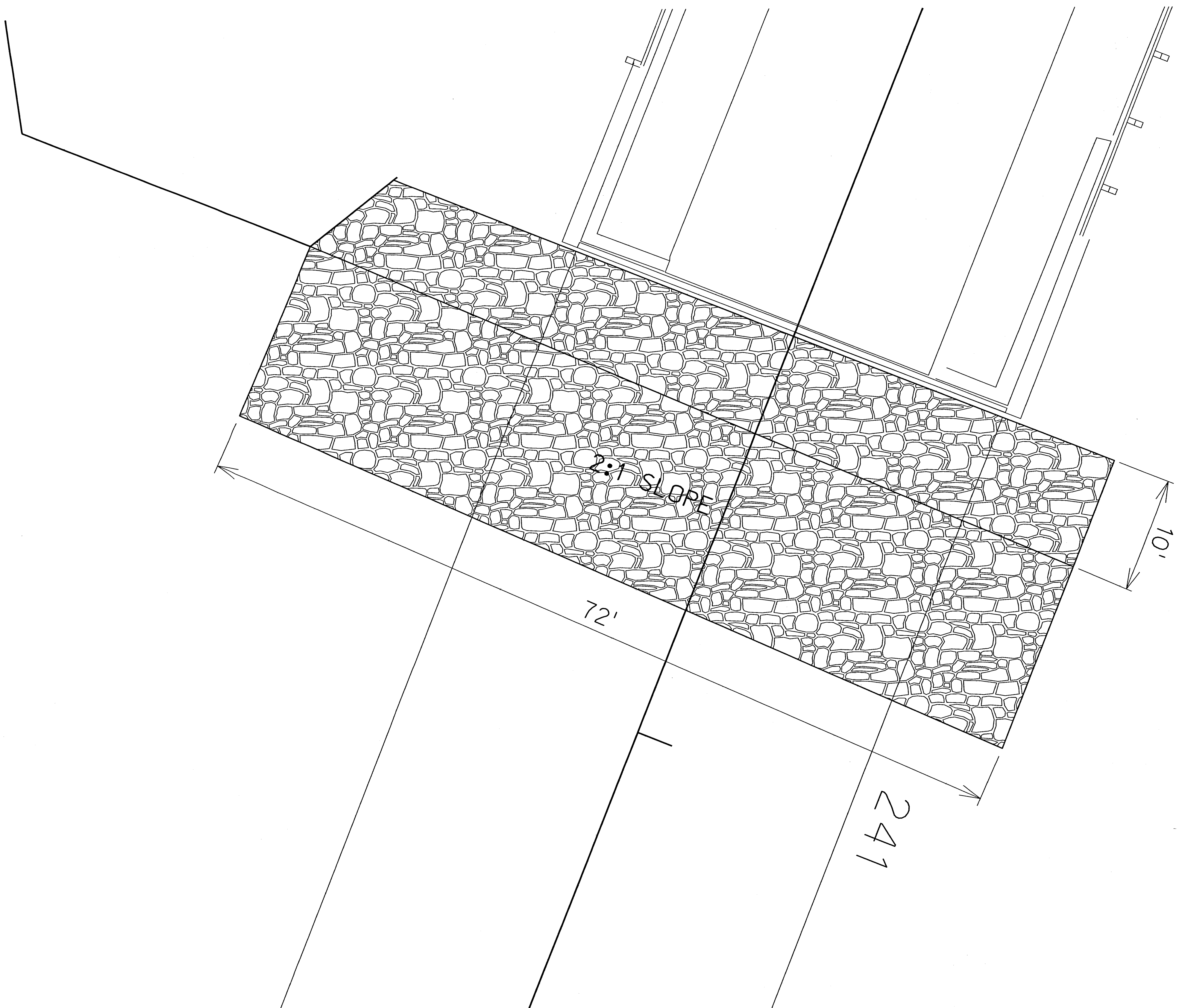

	BUILD ROCK RIPRAP, TYPE C		
STATION	SIDE	TYPE	TONS
240+63 - 240+89	EAST & WEST	CONC.	600

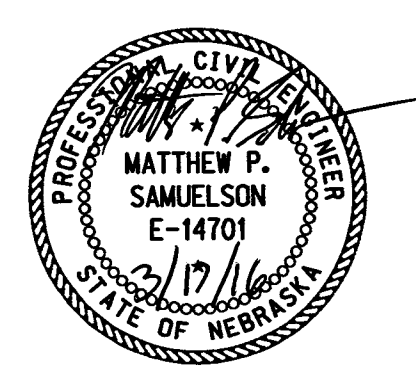

ROADWAY DESIGN DIVISION

COMPUTER\$\$\$\$

USERNAME\$\$\$\$

DATE\$\$\$\$\$\$\$\$\$\$\$\$

DONSPFC\$\$\$\$\$\$\$\$

ROADWAY DESIGN DIVISION

COMPUTER\$\$\$\$

USERNAME\$\$\$\$

DATE\$\$\$\$\$\$\$\$\$\$\$\$\$\$\$\$

DGN\$PEC\$\$\$\$\$\$\$\$\$\$\$\$

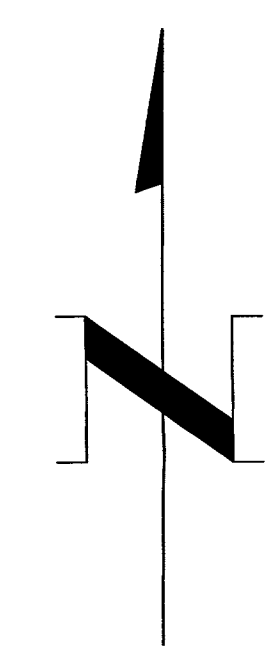
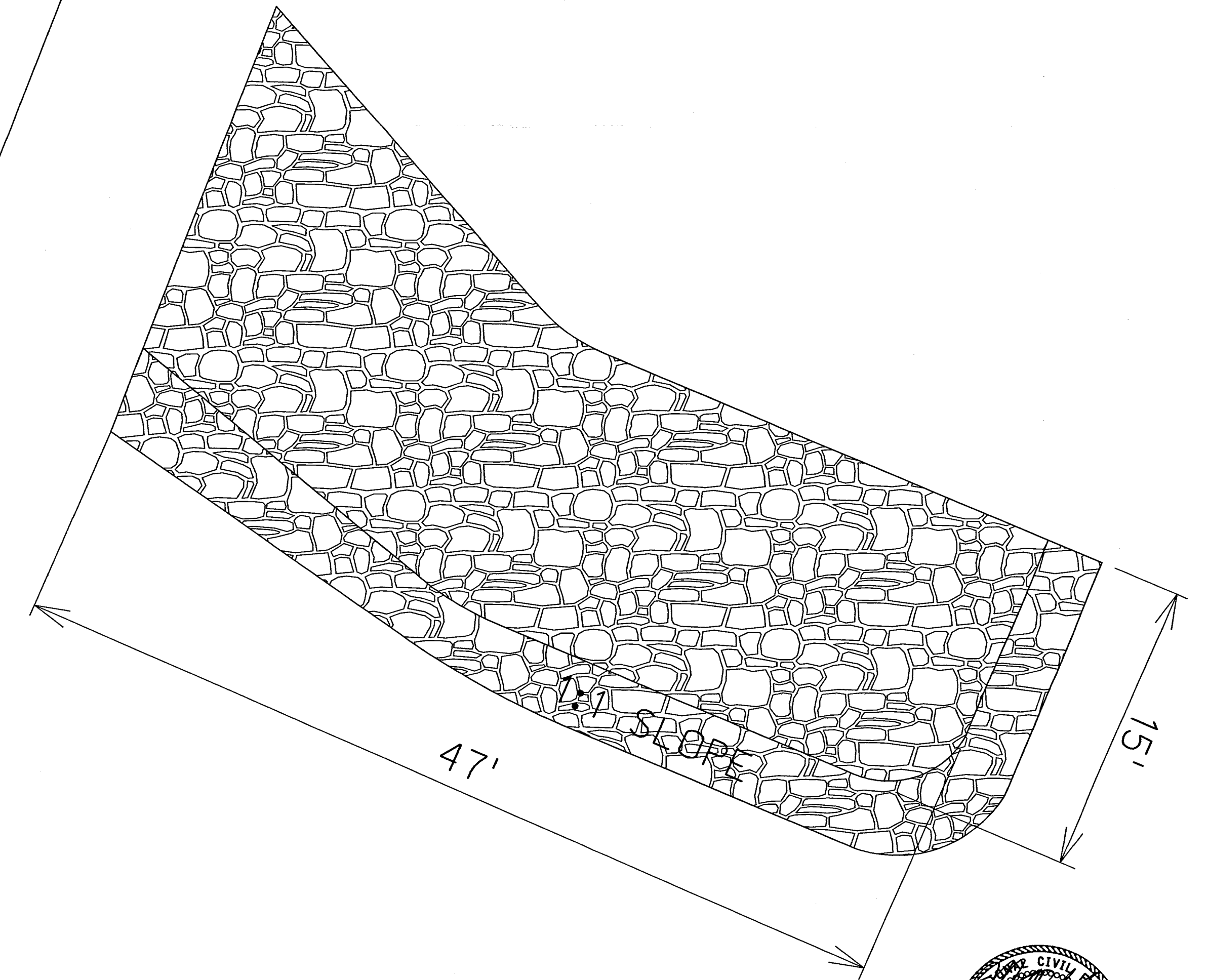
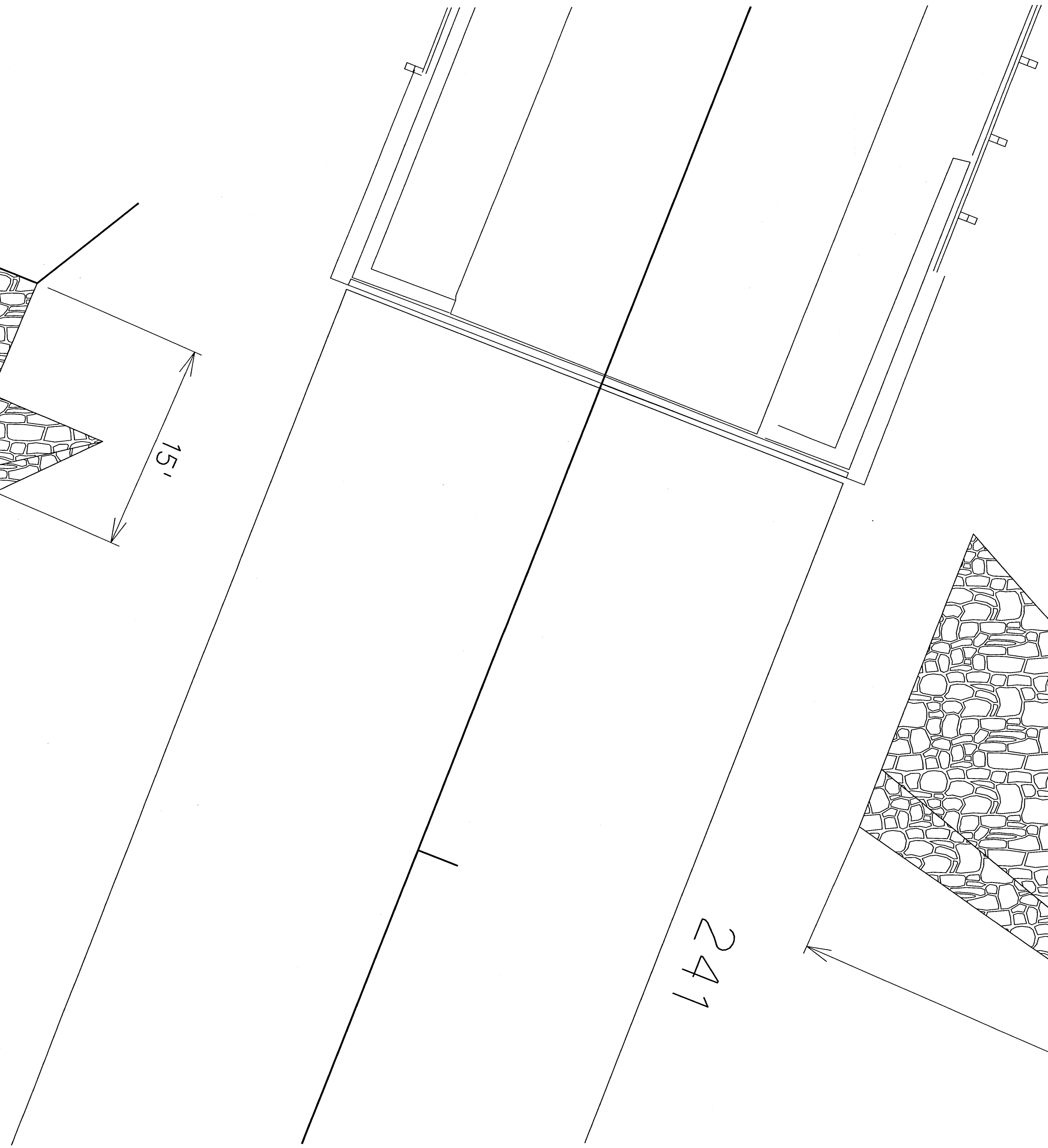
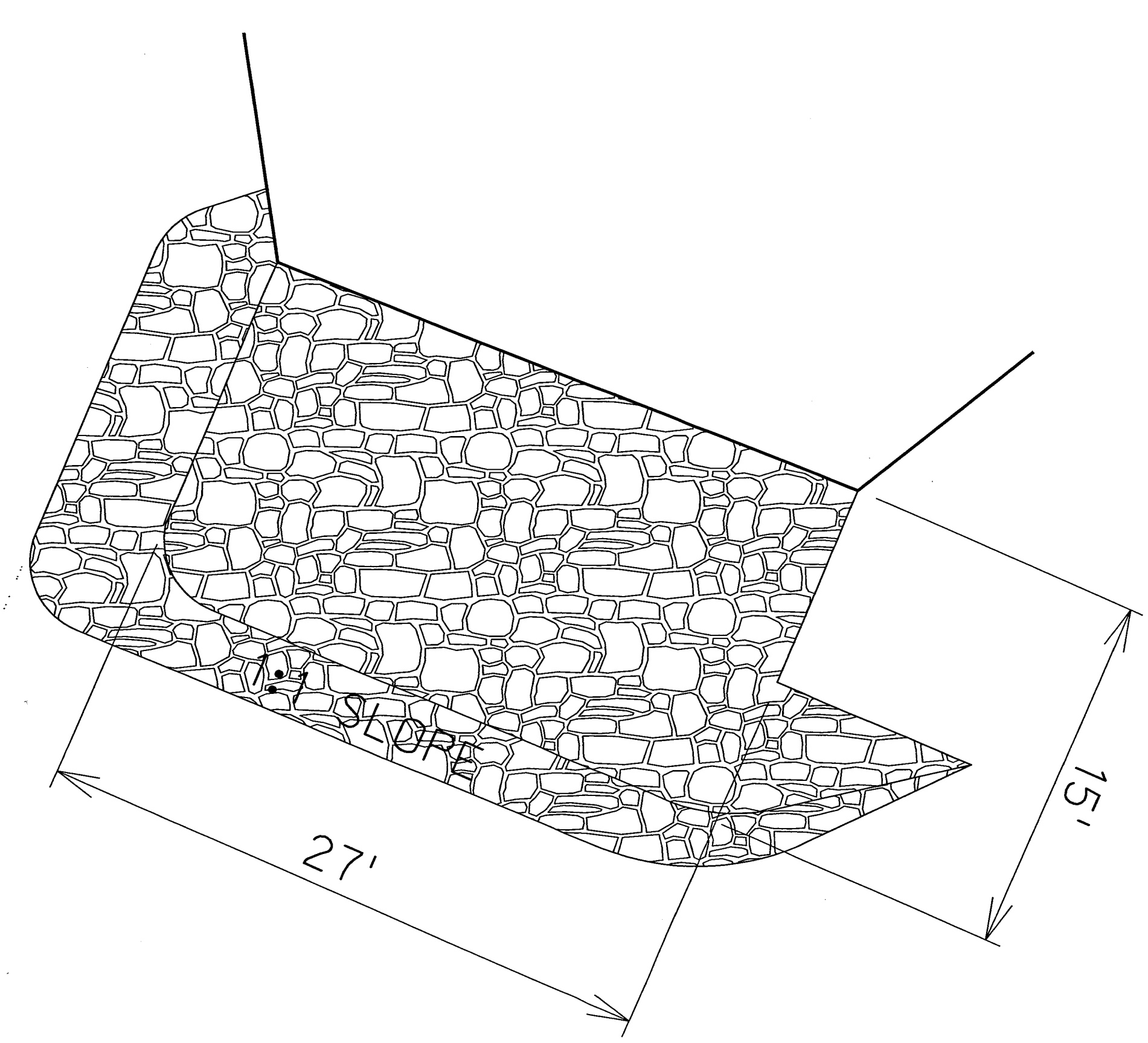

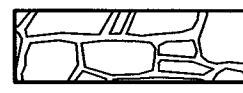
 BUILD TEMPORARY ROCK RIPRAP		
STATION	SIDE	TONS
240+68 - 240+89	WEST	125
240+63 - 240+92	EAST	205

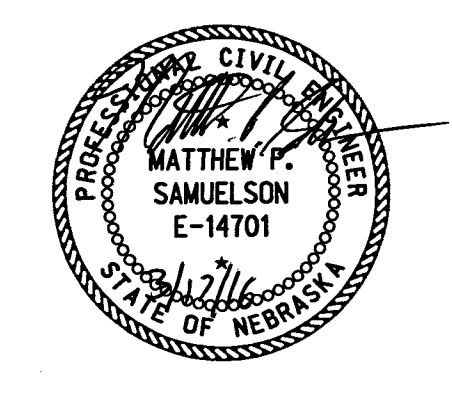

ROADWAY DESIGN DIVISION

COMPUTER\$\$\$\$

USERNAME\$\$\$\$

DATE\$\$\$\$\$\$\$\$\$\$\$\$\$\$\$\$

DGN\$PEC\$\$\$\$\$\$\$\$\$\$\$\$

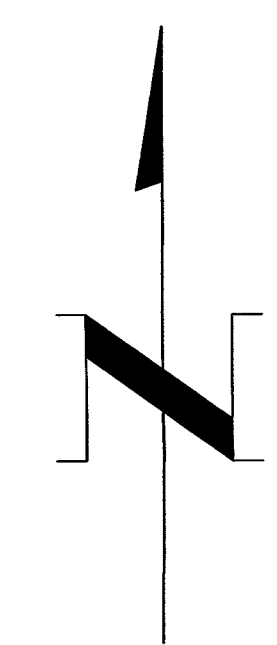
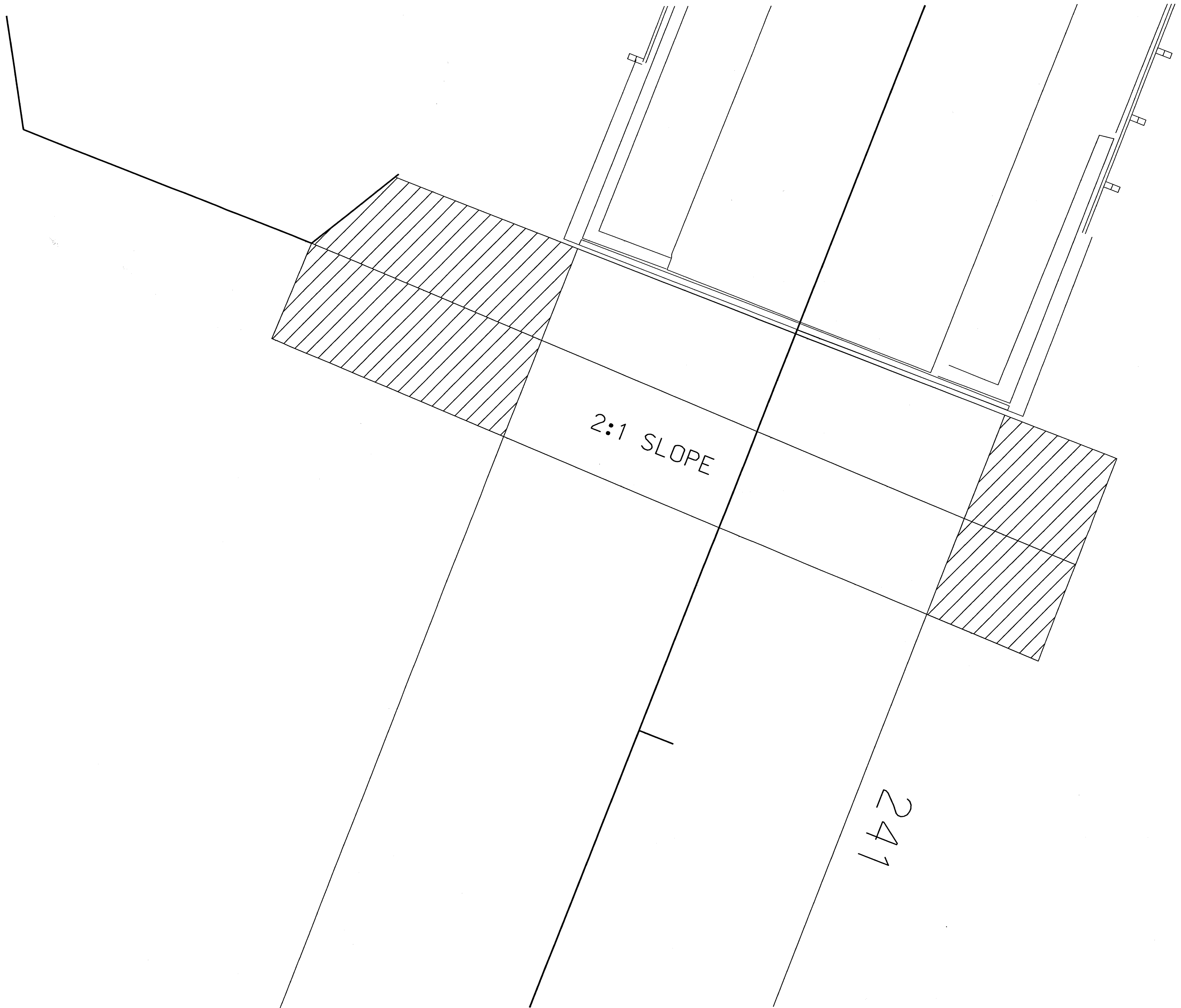

2:1 SLOPE

241

EROSION CONTROL-CLASS 1D, PLAN 501-R6					
STATION	TO	STATION	SIDE	DESCRIPTION	SQ. YDS.
240+63	-	240+82	EAST & WEST	COVER ANY DISTURBED AREAS ABOVE THE ELEVATION OF 1691.5'*	65

*NO NEED TO COVER ANY AREA FROM BRIDGE DRIPLINE TO BRIDGE DRIPLINE

