

INDEX OF SHEETS

SHEET NO.

- 1 TITLE PAGE
- 2-S SUMMARY OF QUANTITIES
- 3 PAVEMENT MARKING QUANTITIES
- 4 PAVEMENT MARKING PLAN--4" PAVEMENT MARKING DETAIL

STANDARD PLANS

- 920-R5 (2 SHEETS) TRAFFIC CONTROL, CONSTRUCTION AND MAINTENANCE
- 921-R5 (2 SHEETS) TRAFFIC CONTROL, CONSTRUCTION AND MAINTENANCE

**STATE OF NEBRASKA
DEPARTMENT OF ROADS**

PLANS FOR CONSTRUCTION

**PAVEMENT MARKING
LANCASTER COUNTY
LANCASTER COUNTY**

PROJECT NO.	SHEET NO.
HRRR-STWD(92)	1
▲ CONTROL NO. 00793	
▲ CONTROL NO.	
■ CONTROL NO.	

THE 2007 EDITION OF THE NEBRASKA STANDARD SPECIFICATIONS AND THE SPECIAL PROVISIONS APPLY TO THIS PROJECT.

THE WORK ON THIS PROJECT CONSISTS OF GROUPS	
8-SPECIALTY	
▲ GROUPS 8 ARE INCLUDED	IN THE LETTING OF MAY 22, 2014
▲ GROUPS ARE INCLUDED	IN THE LETTING OF
■ GROUPS ARE INCLUDED	IN THE LETTING OF

CONSTRUCTION DIVISION

Computer: DRCONSTRUCT10

User: dor17005

Date: 02-APR-2014 09:38

File: 00793set111e.dgn
Scale: 1:100

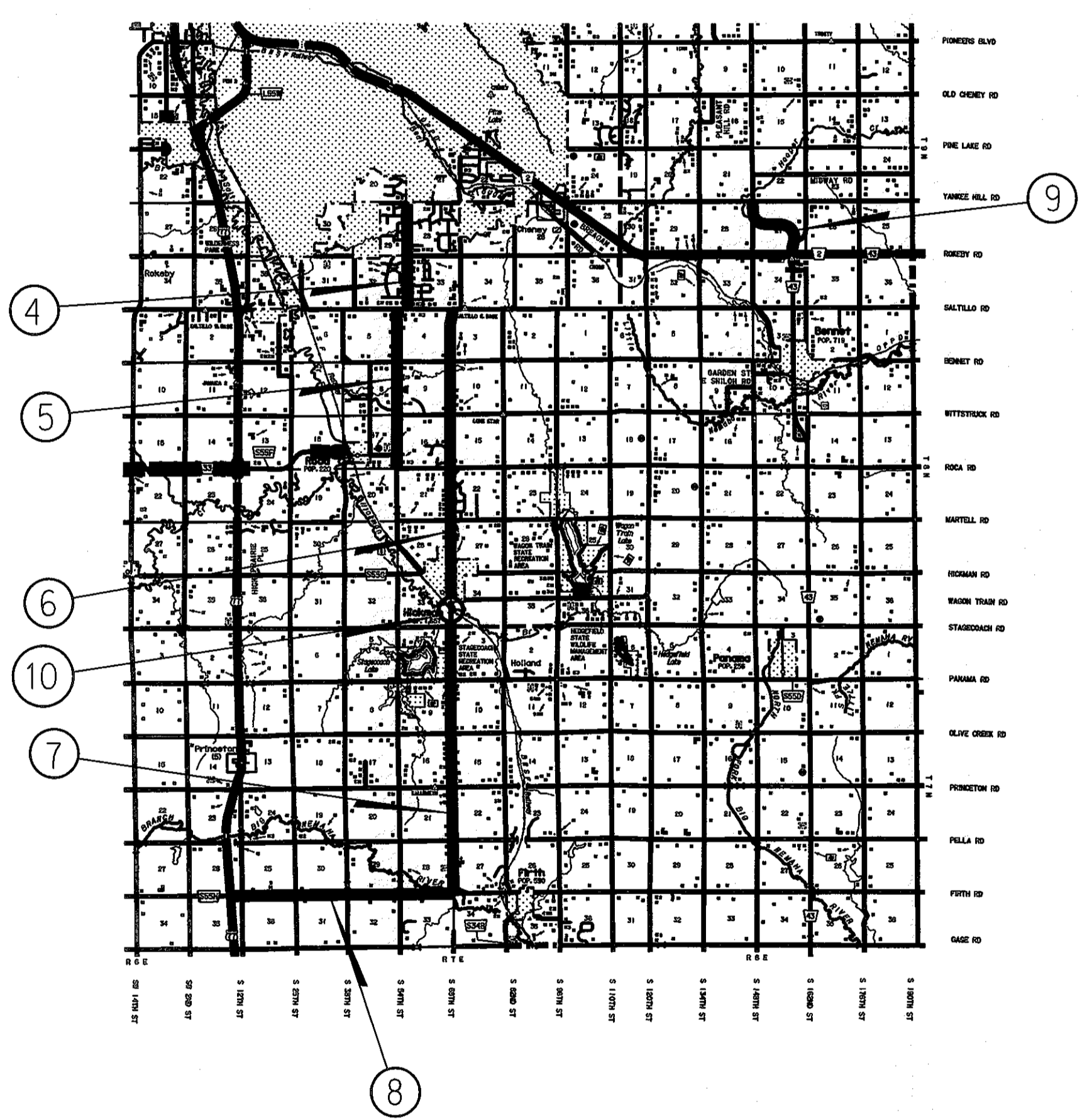
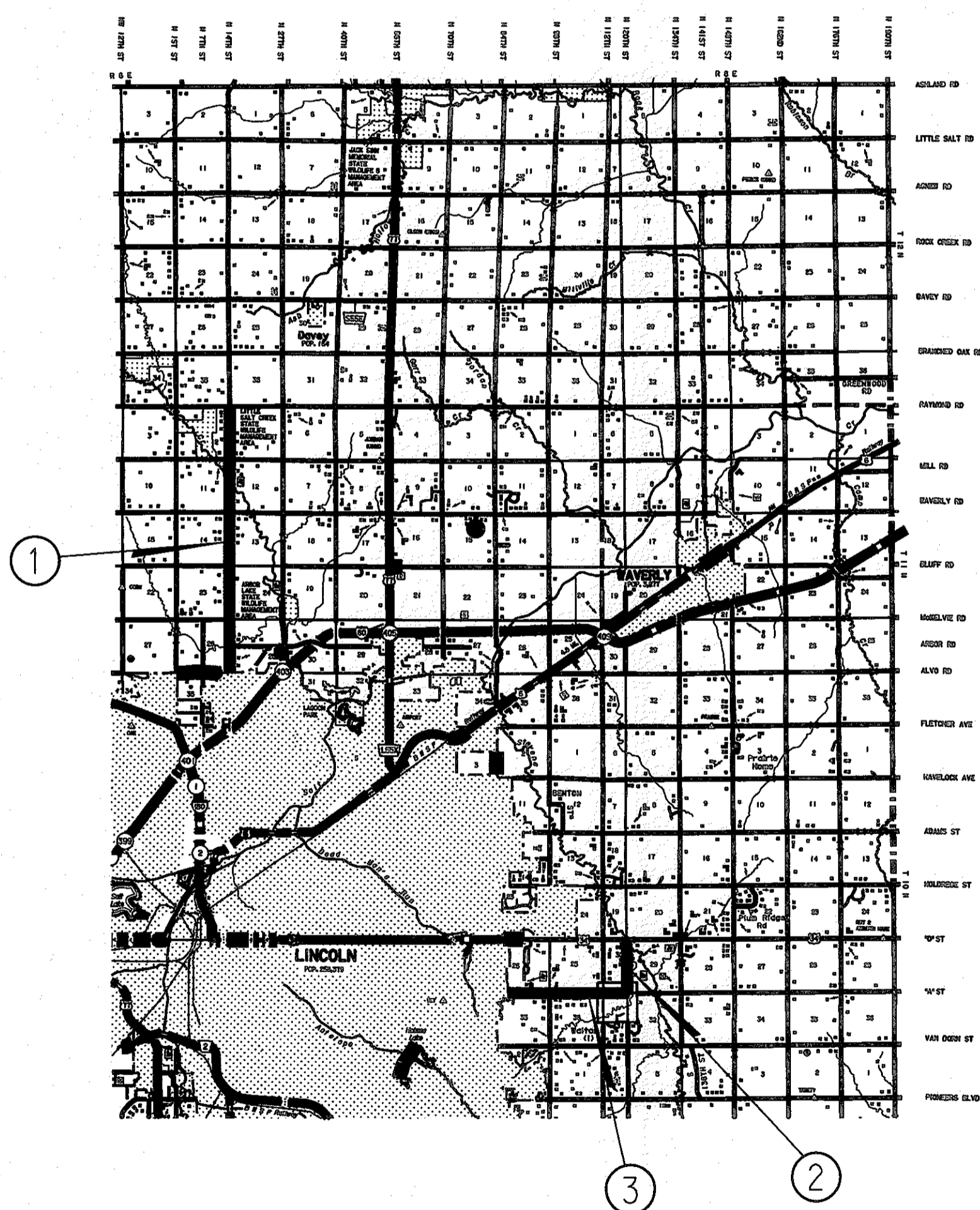

LOCATIONS

SITE	ROAD	BEGIN	END
#1	N 14TH ST	ALVO RD	RAYMOND RD
#2	S 120TH ST	A ST	O ST
#3	A ST	S 86TH ST	S 120TH ST
#4	S 56TH ST	SALTILLO RD	YANKEE HILL RD
#5	S 54TH ST	ROCA RD (EAST)	SALTILLO RD
#6	S 68TH ST	SALTILLO RD	NORTH END OF HICKMAN RR VIADUCT
#7	S 68TH ST	SOUTH END OF HICKMAN RR VIADUCT	FIRTH RD
#8	FIRTH RD	HWY 77	S 68TH ST
#9	HOOPER RD	S 148TH ST	S 158TH ST
#10	S 68TH ST	NORTH END OF HICKMAN RR VIADUCT	SOUTH END OF HICKMAN RR VIADUCT

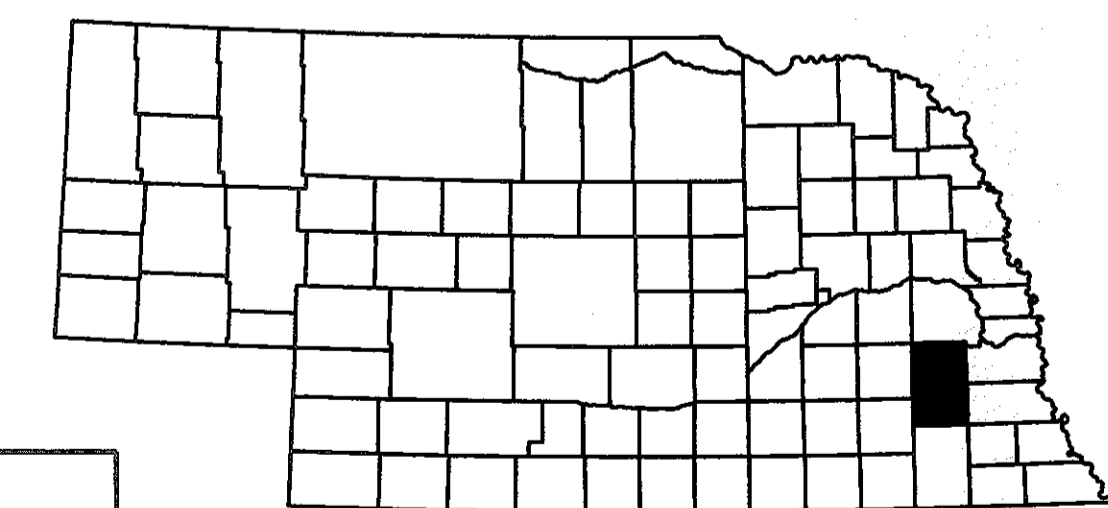

CONVENTIONAL SIGNS

- FENCE R.O.W. OR WIRE
- GUARDRAIL
- TRAVELED WAY
- DIKE
- CULVERT
- POWER POLE
- TELEPHONE POLE
- MAILBOX
- RAILROAD TRACKS
- MARSH
- TREE - CONIFEROUS
- TREE - DECIDUOUS

R.O.W. LEGEND

- NEW CONTROLLED ACCESS
- PREVIOUS CONTROLLED ACCESS
- LIMITS OF CONSTRUCTION
- PREVIOUS R.O.W.
- NEW R.O.W.
- EXISTING PERMANENT EASEMENT
- TEMPORARY EASEMENT
- EXCESS TAKING
- PERMANENT EASEMENT
- EXISTING RAILROAD EASEMENT
- NEW RAILROAD PERMANENT EASEMENT
- NEW RAILROAD TEMPORARY EASEMENT

REFERENCE POST NO. TO REFERENCE POST NO.

EXCEPTIONS: FROM STA. TO STA.

TOTAL NET LENGTH OF PROJECT: FEET MILES

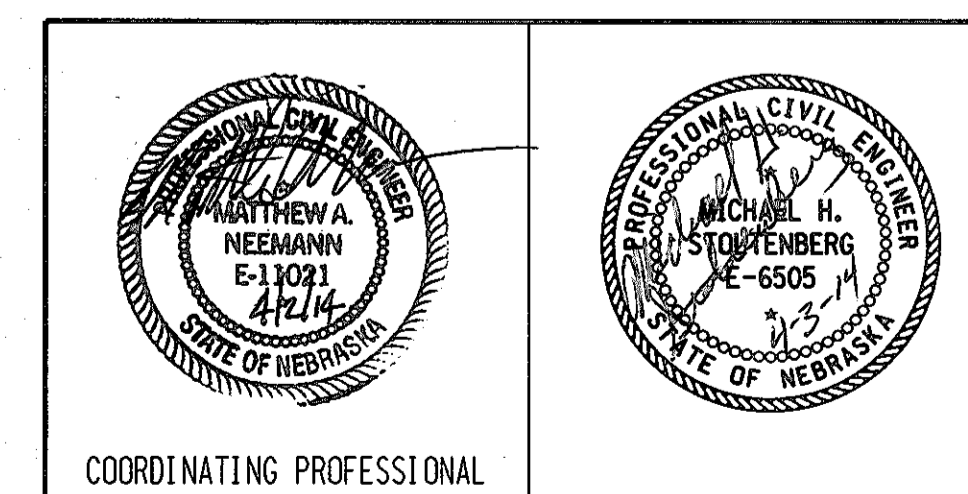

SUMMARY OF QUANTITIES

PROJECT NO.	SHEET NO.
HRRR-STWD(92)	2-S

C.N. 00793

SPECIALTY ITEMS GROUP 8

ITEM	QUANTITY	UNITS
FLAGGING	40.000	DAY
FURNISHING AND OPERATING PILOT VEHICLE	20.000	DAY
MOBILIZATION	1.000	LS
4" WHITE WET REFLECTIVE THERMOPLASTIC PAVEMENT MARKING, GROOVED	303,156.000	LF
4" YELLOW WET REFLECTIVE THERMOPLASTIC PAVEMENT MARKING, GROOVED	178,593.000	LF
4" WHITE WET REFLECTIVE POLYUREA PAVEMENT MARKING, GROOVED	14,538.000	LF
4" YELLOW WET REFLECTIVE POLYUREA PAVEMENT MARKING, GROOVED	12,276.000	LF

CONSTRUCTION DIVISION

Computer: DRCONSTRUCTIO

User: dor7005

Date: 02-APR-2014 09:38

File: 00793psheet11a.dgn
Scale: 1:100

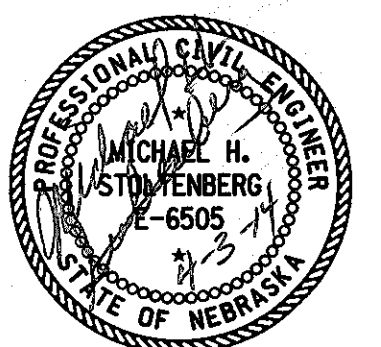

HRRR-STWD(92) PAVEMENT MARKING LANCASTER COUNTY

LOCATION			PAVEMENT MARKINGS (LINEAR FOOT)							
ROAD	BEGIN	END	WHITE	YELLOW			WHITE	YELLOW		
			4" WET REFLECTIVE POLYUREA, GROOVED SINGLE LINES	SKIP LINE	SINGLE LINES	DOUBLE LINES	4" WET REFLECTIVE THERMOPLASTIC, GROOVED SINGLE LINES	SKIP LINE	SINGLE LINES	DOUBLE LINES
N 14TH ST	ALVO RD	RAYMOND RD					53,489	5,434	18,423	1,742
S 120TH ST	A ST	O ST					10,572	1,046	2,170	2,064
A ST	S 86TH ST	S 120TH ST					23,868	2,466	5,054	3,954
S 56TH ST	SALTILLO RD	YANKEE HILL RD					22,247	57		27,746
S 54TH ST	ROCA ROAD (EAST)	SALTILLO RD					31,670	3,775	8,815	930
S 68TH ST	SALTILLO RD	NORTH END OF HICKMAN RR VIADUCT					59,563	4,085	10,836	32,232
S 68TH ST	SOUTH END OF HICKMAN RR VIADUCT	FIRTH RD					57,677	2,951	14,028	14,080
FIRTH RD	HWY 77	S 68TH ST					44,070	5,282	9,811	1,612
HOOPER RD	S 148TH ST	S 158TH ST	12,846	644	2,402	7,692				
S 68TH ST	NORTH END OF HICKMAN RR VIADUCT	SOUTH END OF HICKMAN RR VIADUCT	1,692	52	206	1,280				
TOTALS (LINEAR FOOT)			14,538	12,276			303,156	178,593		

File: CN 00793 HRRR-STWD(92) Pavement Marking Lancaster County.dgn Date: 13-MAR-2014 14:55
 Scale: 1:100 Computer: DRTRAFIC20 User: dor23056
 TRAFFIC ENGINEERING DIVISION

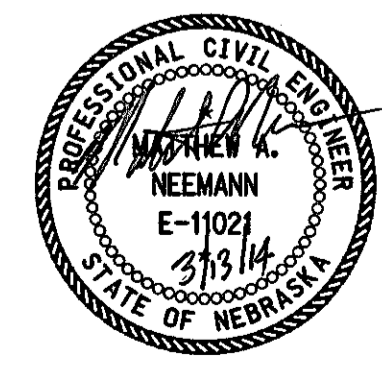

NEBRASKA DEPARTMENT OF ROADS			
TRAFFIC ENGINEERING DIVISION			
PAVEMENT MARKING QUANTITIES			
DESIGNED	SR	HRRR-STWD(92)	(11)
REVIEWED		LANCASTER COUNTY	
APPROVED	DATE DRAWN	TRAFFIC ENGINEER	DATE
	03/14		

TRAFFIC ENGINEERING DIVISION
Computer: DRTRAFFIC20
User: dor23056
Date: 07-MAR-2014 09:23
File: psetpdm-1 r1.dgn
Scale: 1:100

2 LANE ROADWAYS WITH CURBS

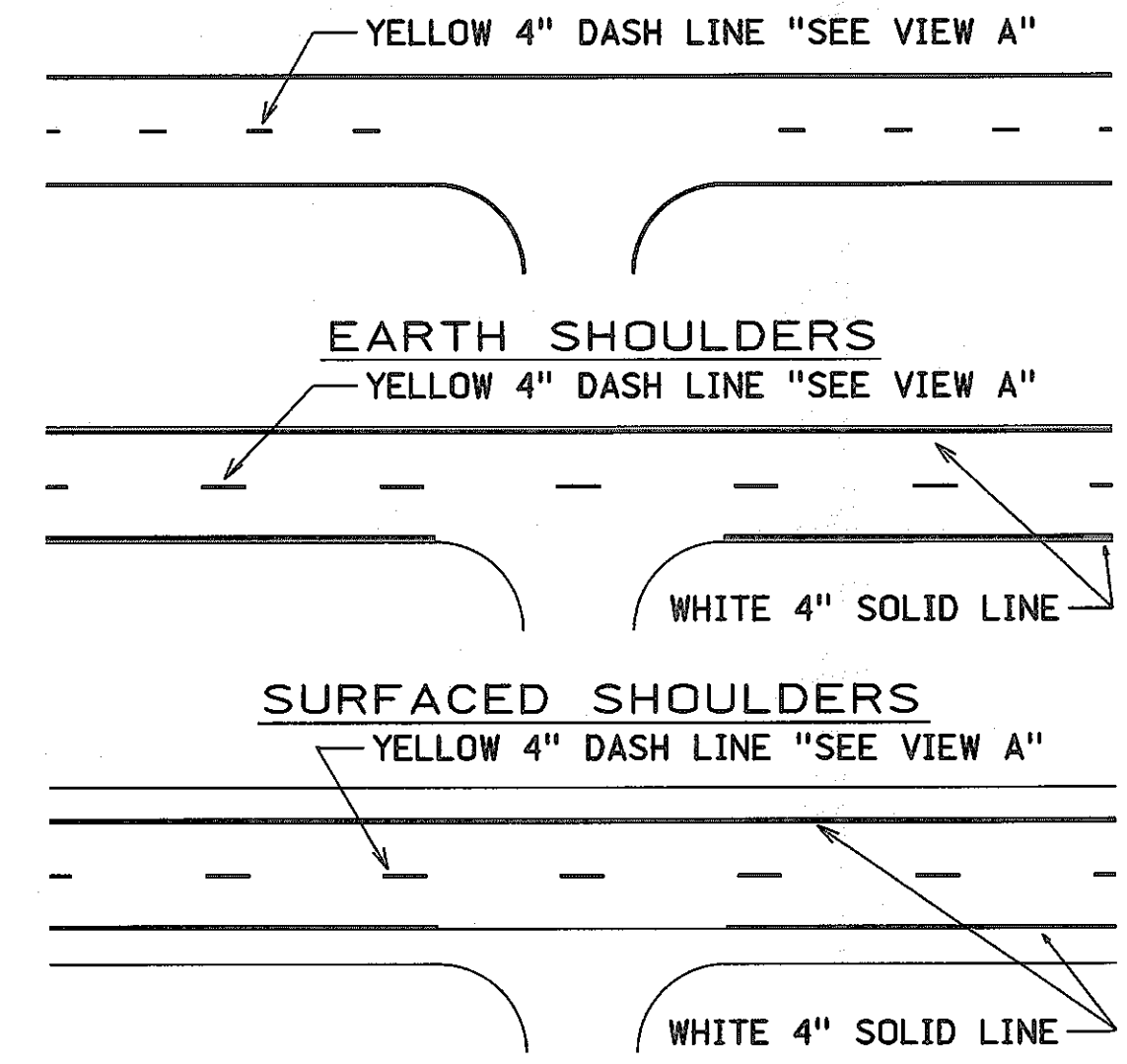

4 LANE DIVIDED ROADWAY

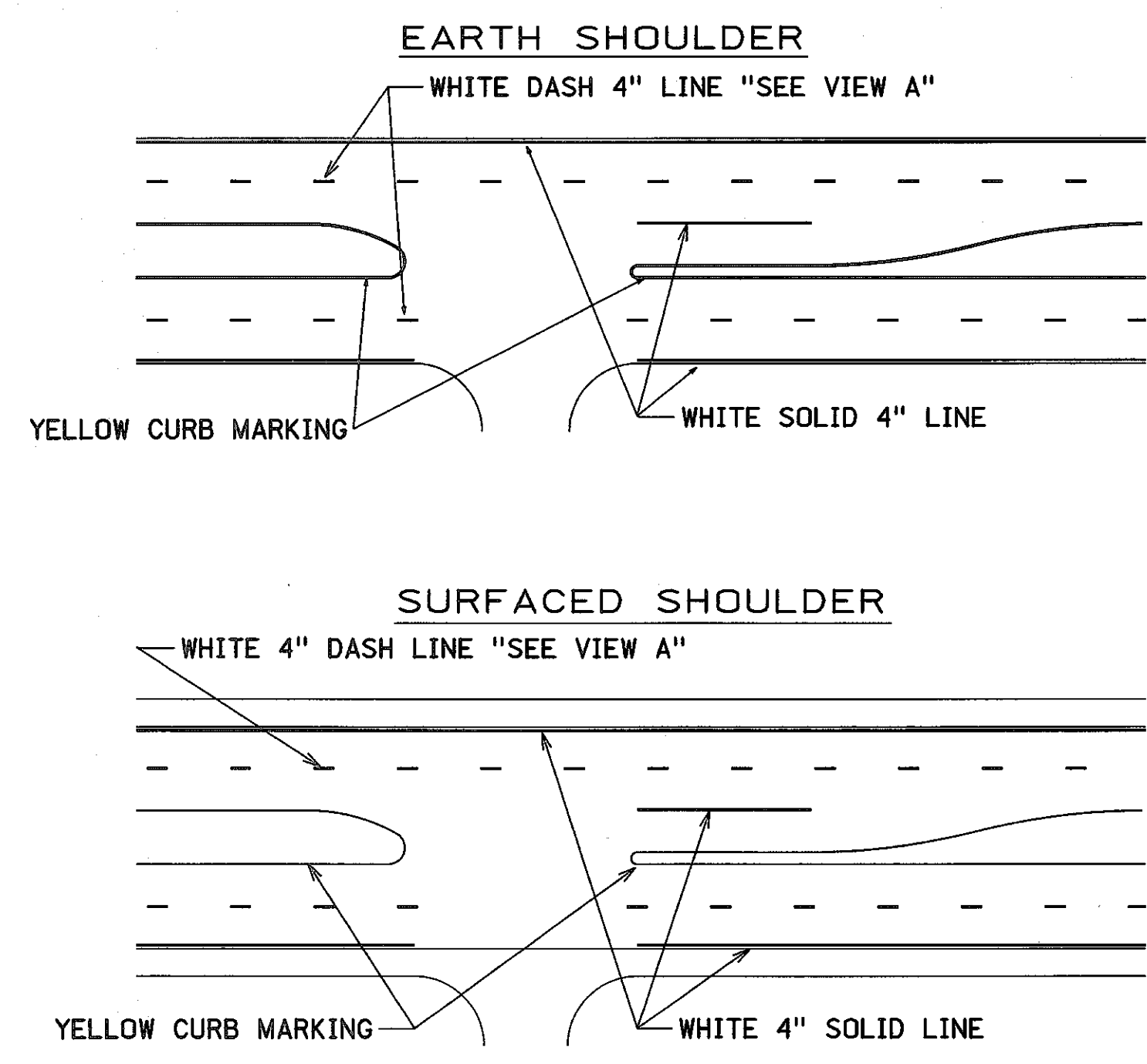

2-LANE ROADWAY REQUIRED LOCATION FOR EDGE LINES		
ROADWAY WIDTH	SHOULDER TYPE	DISTANCE FROM CENTERLINE OF ROADWAY TO OUTSIDE EDGE OF PAVEMENT EDGELINE
LESS THAN 24 FT	SURFACED	12 FT 0 IN
LESS THAN 24 FT	EARTH	PAVEMENT EDGE
24 FT	EARTH	PAVEMENT EDGE
24 FT	SURFACED	12 FT 0 IN
GREATER THAN 24 FT	EARTH	12 FT 0 IN

CENTERLINE MARKING SHALL BE PLACED ON THE "SOUTH" SIDE OF THE CENTER JOINT ON EAST-WEST ROADS AND ON THE "EAST" SIDE OF THE CENTER JOINT ON NORTH-SOUTH ROADS

4 LANE ROADWAYS NO CURBS

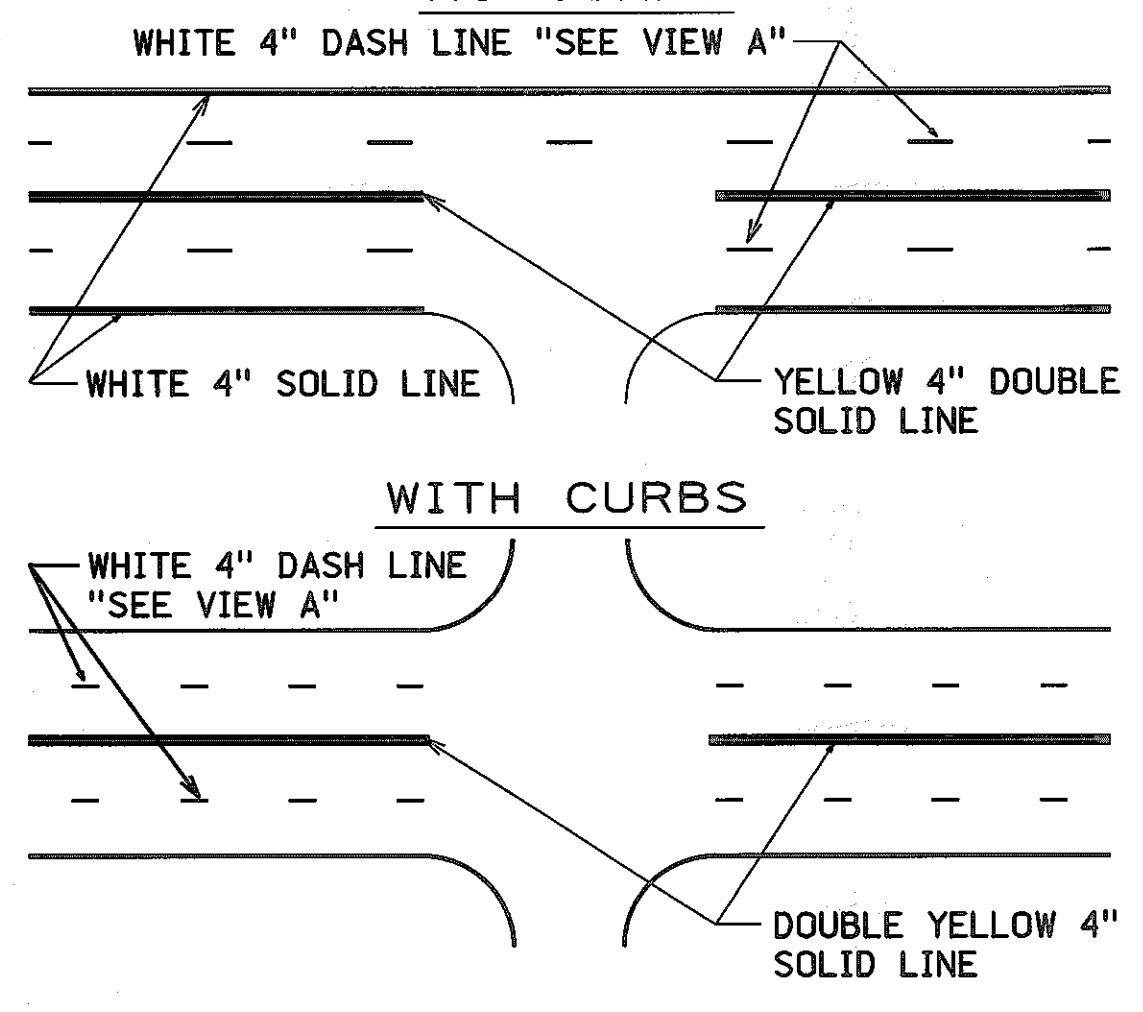

DEPRESSED MEDIAN

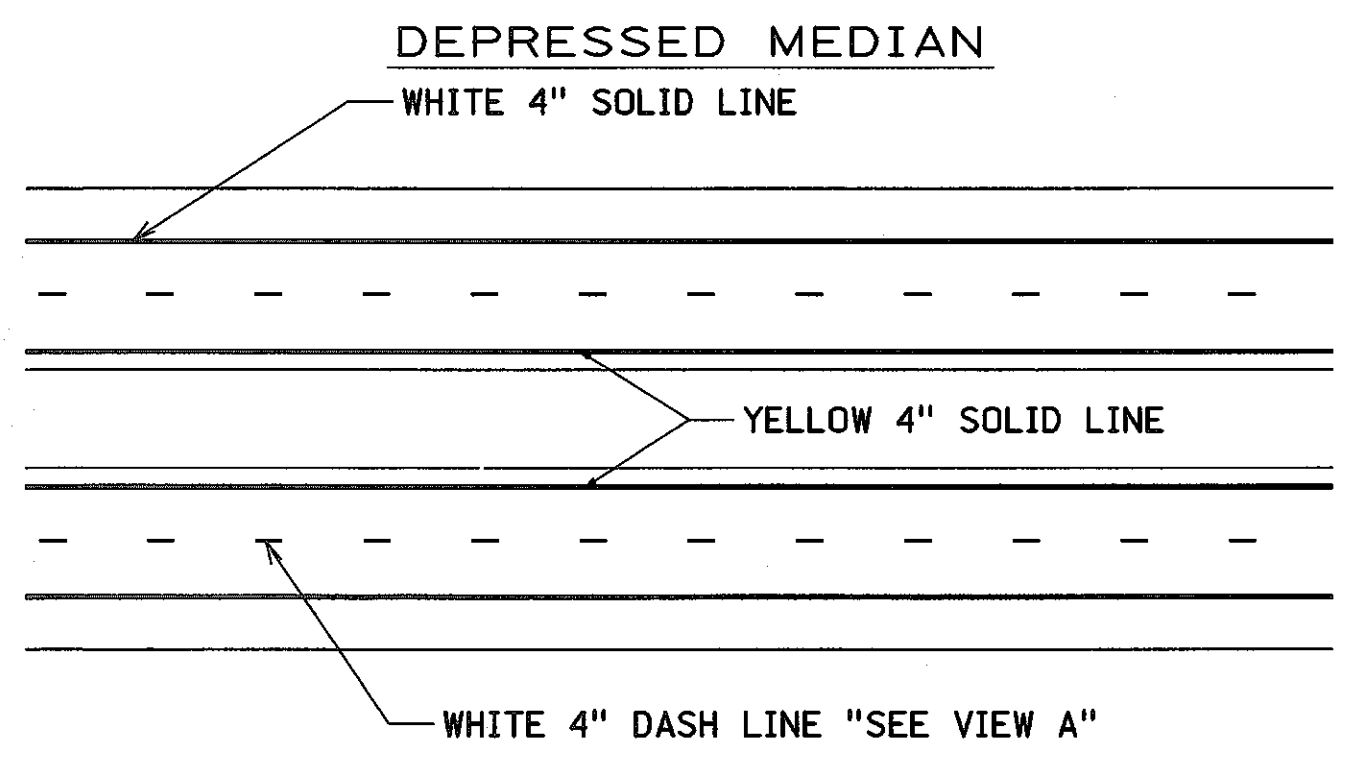

3 OR 5 LANE WITH COMMON LEFT TURN LANE

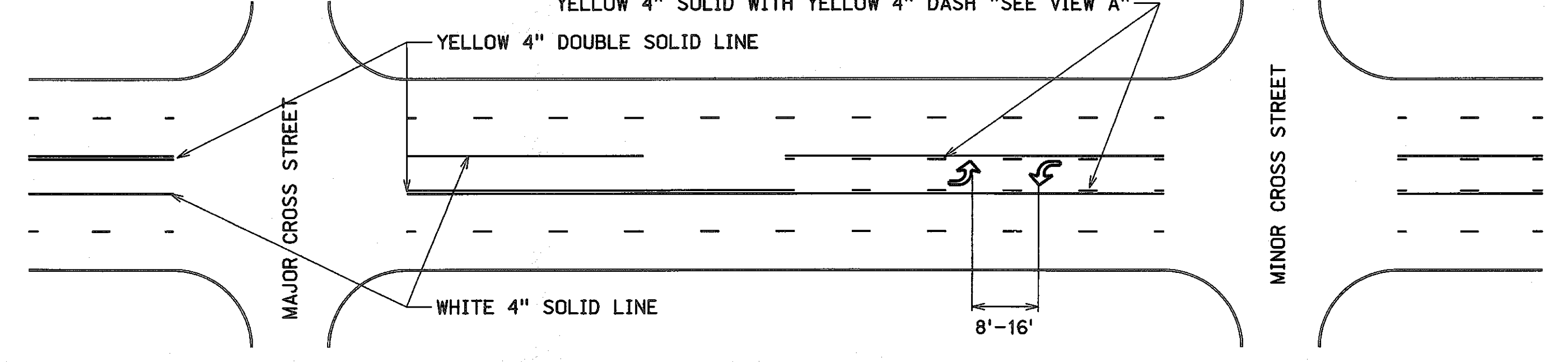

GORE MARKINGS (NON-FREEWAY)

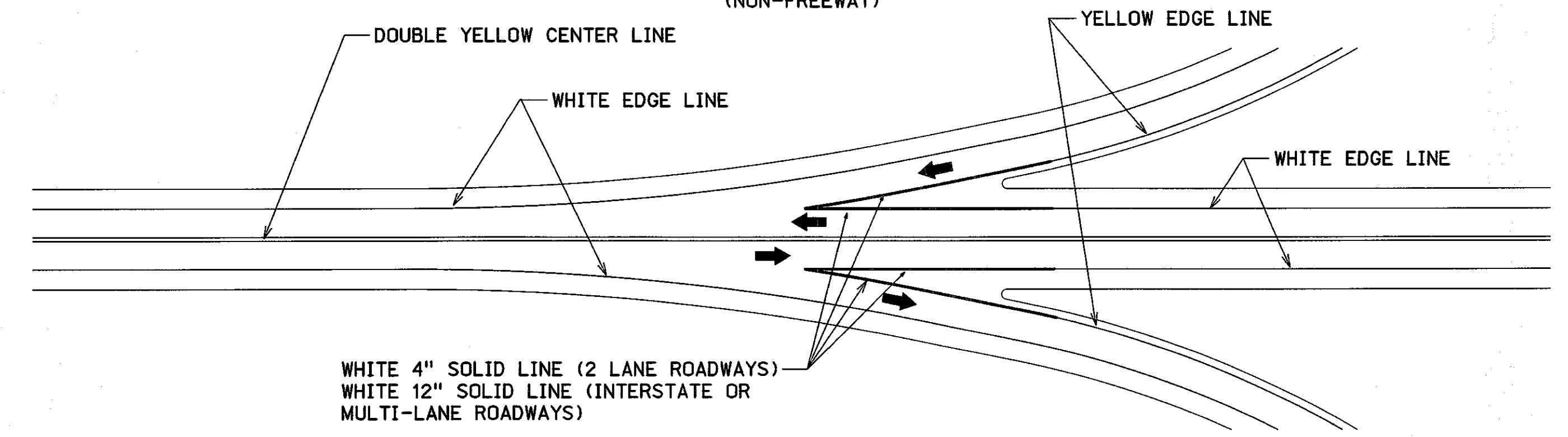

ISLAND MARKING

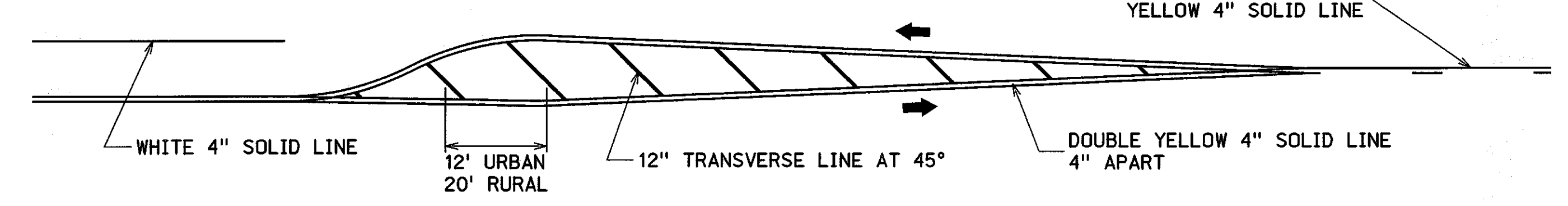

PASSING LANE MARKING

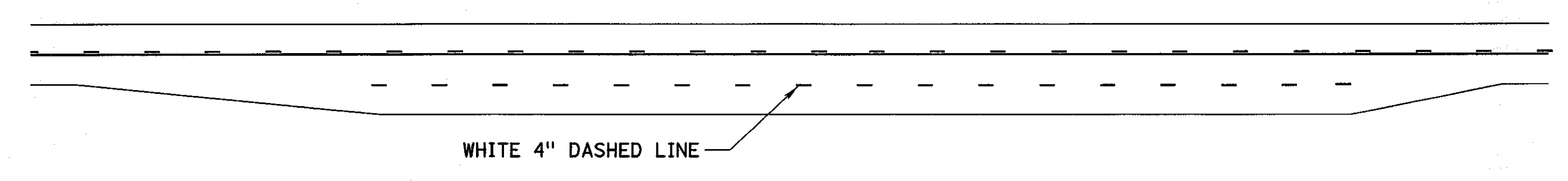

FLY-BY LANE MARKING

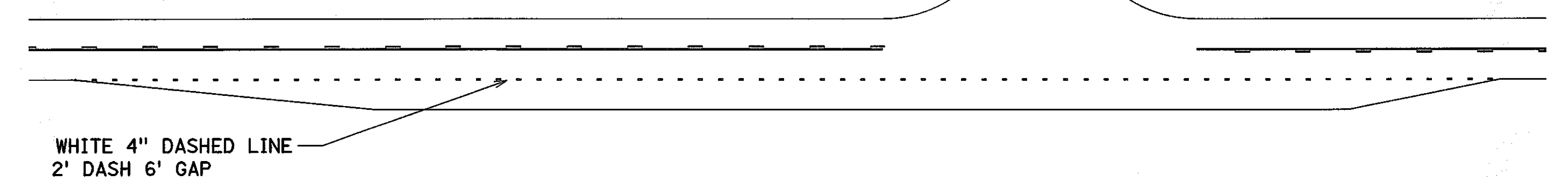

TYPICAL NO PASSING ZONE MARKINGS

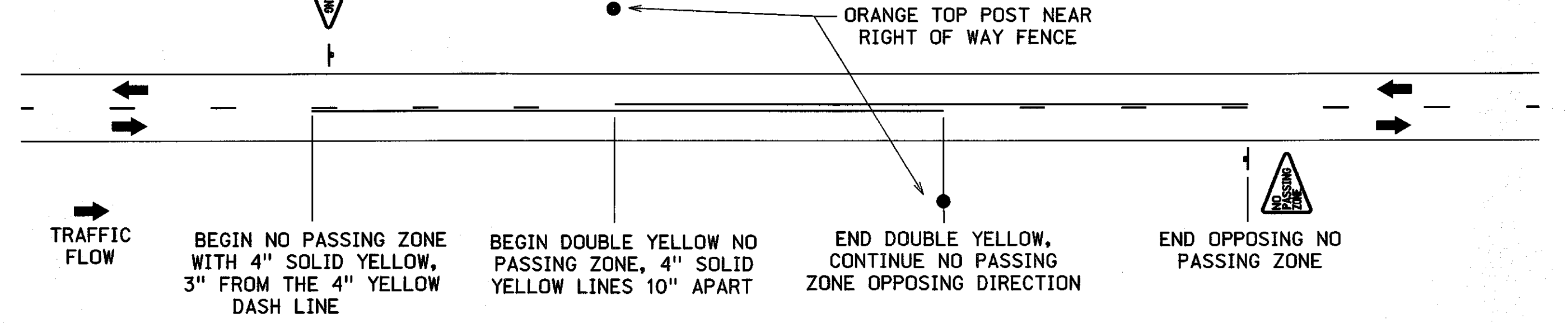

VIEW A

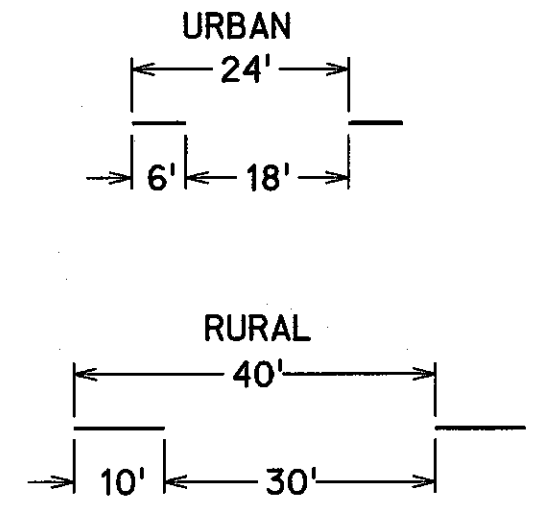

PERMANENT PAVEMENT MARKINGS INSTALLED IN GROOVES

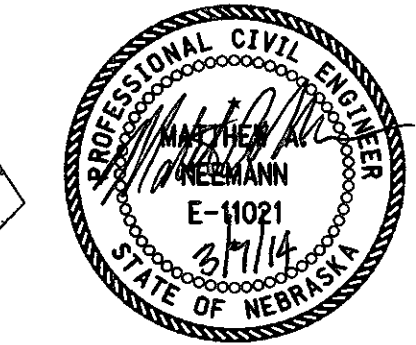
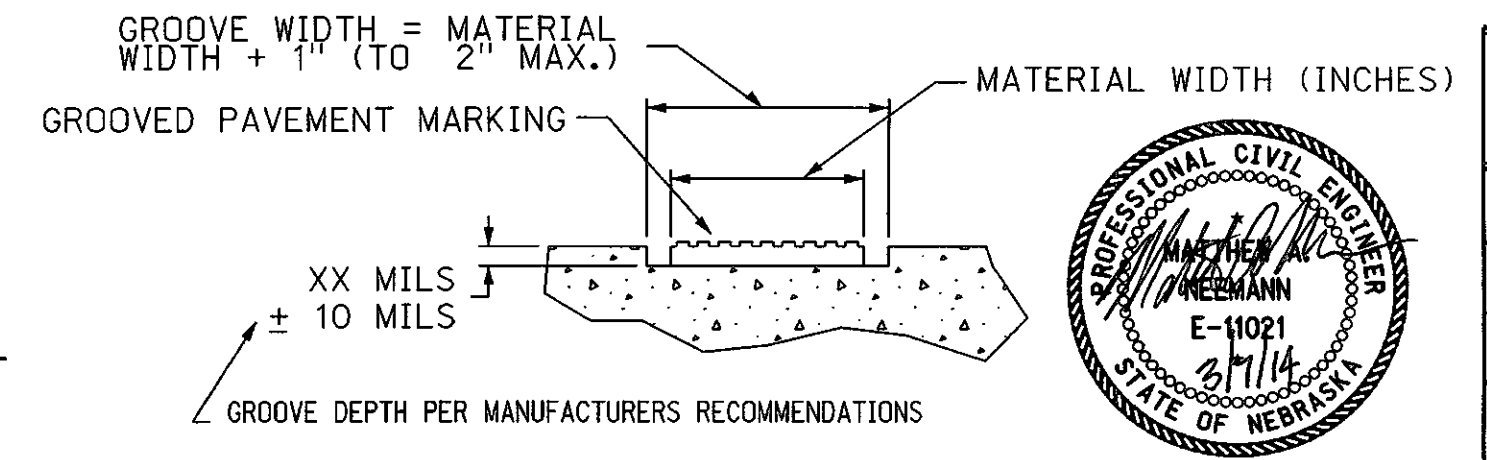

NEBRASKA DEPARTMENT OF ROADS TRAFFIC ENGINEERING DIVISION			
PAVEMENT MARKING PLAN			
DESIGNED	TJF	4" PAVEMENT MARKING DETAIL	
REVIEWED			
APPROVED	DATE DRAWN	TRAFFIC ENGINEER	DATE
	12/12		